

REHAB FLAT
SALE FLAT

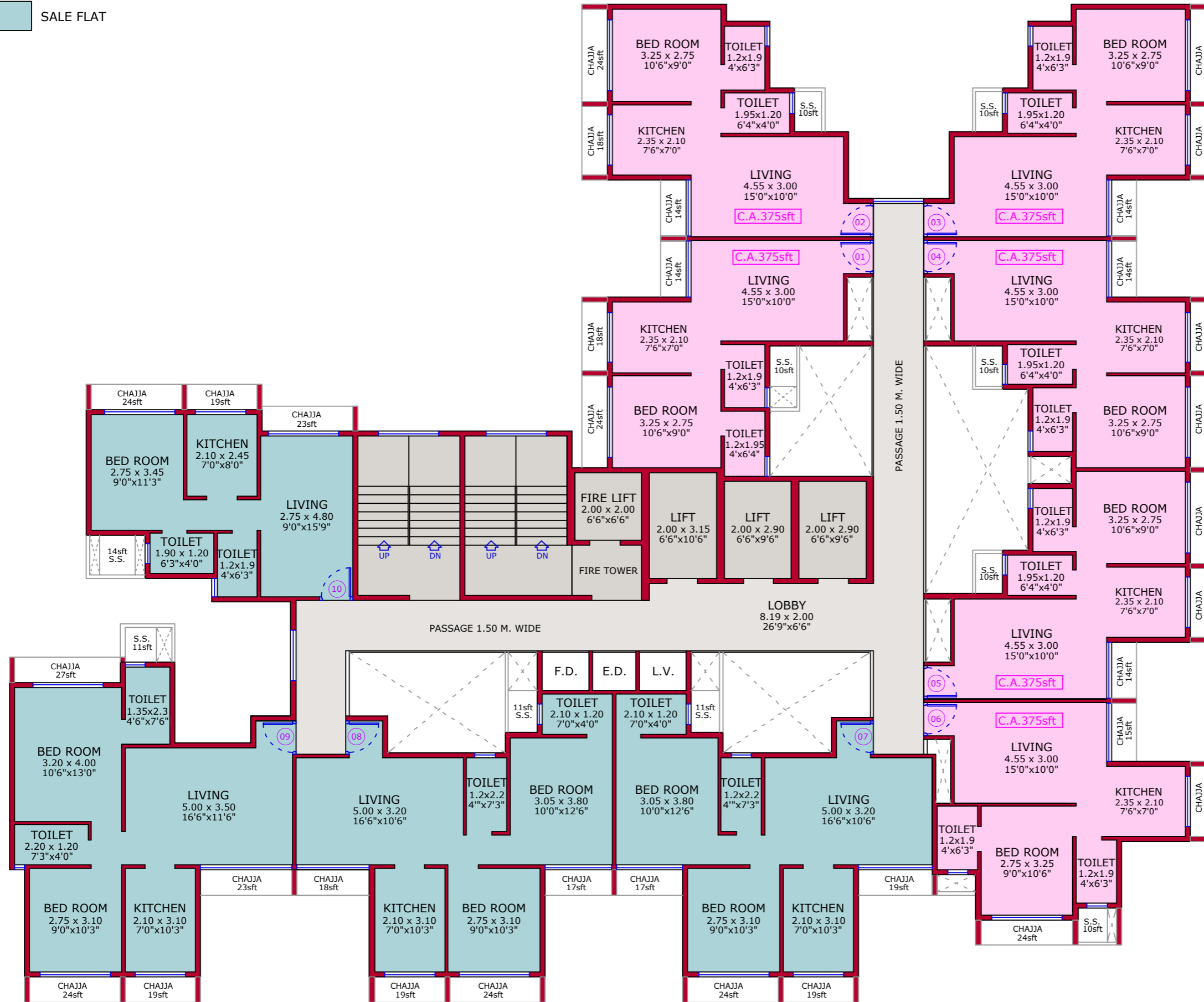

PROJECT

PROPOSED RESIDENTIAL BUILDING ON PLOT NO.- 11, SECTOR-10, SANPADA NAVI MUMBAI.

OWNER

DEVELOPERS

NORTH



FLOOR

TYPICAL FLOOR PLAN
(8TH,9TH,10TH,11TH,13TH, 14TH,15TH,16TH,18TH, 19TH,20TH,21ST)

ARCHITECTS

TRIARCH DESIGN STUDIO
ARCHITECTS AND INTERIOR DESIGNERS

HEAD OFFICE : BHAGAVATI BHUVAN, SARASWATI RAJG, JOGESHWARI (E), MUMBAI-400 060. TEL: 28354441.
BRANCH OFFICE : 18, GAURI COMMERCIAL COMPLEX, PLOT NO 19, SECTOR 11, C.B.D., BELAPUR, NAVI MUMBAI. TEL: 27580813, 49245567.

NOTES : ① THE INFORMATION CONTAINED IN THIS LEAFLET/PLAN/DRAWING IS INDICATIVE OF DEVELOPMENT THAT IS PROPOSED SUBJECT TO APPROVAL OF THE AUTHORITIES OR IN THE INTEREST OF CONTINUING IMPROVEMENT. THE ARCHITECT/DEVELOPER RESERVE THE RIGHT TO CHANGE THE PLAN. ② ELEVATIONAL FEATURES SHOWN IN DRAWINGS MAY BE CHANGED AS APPROVED AT THE TIME OF EXECUTION ON SITE. ③ ALL ROOMS/SHOPS DIMENSIONS ARE UNFINISHED DIMENSIONS. ④ ROOM SIZES ARE INCLUSIVE OF ENCLOSED BALCONY & CUPBOARD, IF PROVIDED ⑤ DIMENSIONS SHOWN IN FEET & INCHES ARE ROUNDED OFF. ⑥ ACTUAL ROOM DIMENSIONS MAY VARY DUE TO PLASTERING, TILING & DUE TO STRUCTURAL MEMBERS LIKE COLUMNS/SKIRTINGS ETC.